



## DIMENSIONAL SPECIFICATIONS

MODEL	WIDTH	HEIGHT	DEPTH	WEIGHT
<i>English (inches)</i>				
13DV1A/15DV1A	2.80	1.30	3.30	2.64 oz.
13DV2A/15DV2A	2.80	1.50	3.30	2.94 oz.
13DV-E/15DV-E	3.81	5.50	3.50	10.00 oz.
<i>Metric (centimeters)</i>				
13DV1A/15DV1A	7.20	3.30	8.40	75 gm.
13DV2A/15DV2A	7.20	3.90	8.40	83 gm.
13DV-E/15DV-E	9.68	13.96	8.89	284 gm

## OPERATING CONDITIONS

Temperature ..... -10° to +45° C.  
 AC Input Voltage ..... ±10% Rated Line Voltage  
 Input Frequency ..... 50/60 Hz.

## ELECTRICAL SPECIFICATIONS AC INPUT 50/60 HZ

MAXIMUM MODEL	MAX. CONTINUOUS AC AMPS	CONTINUOUS ARM AMPS*	MAX HP
<i>12 VAC Single Phase Input, 0-11 VDC Output</i>			
13DVA	2.6	2.0	1/40
13DV-E	3.9	3.0	1/25
<i>24 VAC Single Phase Input, 0-22 VDC Output</i>			
13DVA	2.6	2.0	1/20
13DV-E	3.9	3.0	1/12
<i>120 VAC Single Phase Input, 0-90 VDC Output</i>			
15DVA	2.6	2.0	1/6
15DV-E	3.9	3.0	1/3
<i>240 VAC Single Phase Input, 0-180 VDC Output</i>			
15DVA	2.6	2.0	1/3
15DV-E	3.9	3.0	2/3

\* Minimum Armature Amps: 150mA D.C.

## HOOK-UP DIAGRAM

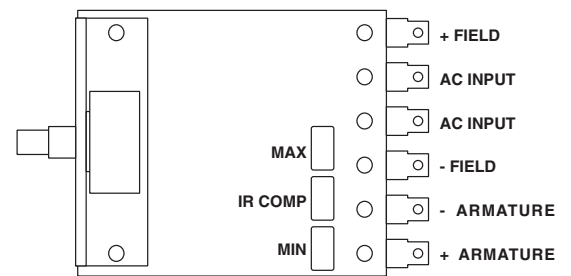

## HEATSINK DIMENSIONS AND STYLES

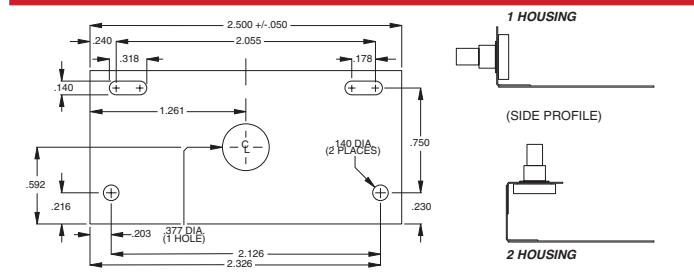

## OPTION DESCRIPTION

OPTION	SUFFIX
Single pole AC switch integral with speedpot for 120 VAC application only .....	-104
3-position terminal strip with speedpot, dial, & knob kit .....	-TS

# 15 Series Adjustable Speed DC Control

The 15 Series is a general purpose, economical variable speed control for small DC and universal motor applications featuring: **dual input voltages of 12/24 VAC or 120/240 VAC** with a DC output current rating of 2 Amps, adjustable trimpot settings, and quick connect terminal pins. **The 15 Series is available in two compact panel mount styles and a NEMA 4/12 enclosed model.**

## 15 SERIES STANDARD FEATURES

- Dual voltage models of 12/24 VAC or 120/240 VAC input
- Full wave bridge power supply
- Adjustable Minimum speed (0-30% of max)
- Adjustable Maximum speed (40-145% of base)
- Adjustable IR Compensation
- Fixed Acceleration (0.5 seconds)
- 5K ohm speed potentiometer with leads, knob & dial included
- 25:1 speed range • 1% speed regulation
- Shunt field supply provided (1 Amp max)
  - 10V for 12 VAC; 20V for 24 VAC input,
  - 100V for 120 VAC; 200V for 240 VAC input
- Overload capacity of 200% for 1 minute
- Transient voltage protection
- AC line fuse
- Power on/off switch } Enclosed Model

## 15 SERIES SELECTION GUIDE

Suffix -1 and -2 refer to mounting configuration, see diagram below.

MODEL	DC OUTPUT CURRENT	INPUT	OUTPUT
13DV1A	2 Amps*	12/24 VAC	0-11/0-22 VDC
13DV2A	2 Amps*	12/24 VAC	0-11/0-22 VDC
13DV-E	3 Amps	12/24 VAC	0-11/0-22 VDC
15DV1A	2 Amps*	120/240 VAC	0-90/0-180 VDC
15DV2A	2 Amps*	120/240 VAC	0-90/0-180 VDC
15DV-E	3 Amps	120/240 VAC	0-90/0-180 VDC

\* Rating for D.C. Output Current can be increased from 2.0 to 4.0 amps w/suitable external heatsink (equiv. to 4" x 4" x .125" aluminum plate).